



# QUADRA RM

Extruded Aluminum LED Running Man

Project Name: \_\_\_\_\_ Model Number: \_\_\_\_\_  
Prepared By: \_\_\_\_\_ Date: \_\_\_\_\_

## FEATURES & BENEFITS

- Wall, ceiling or end mounting
- High-output LED technology
- Extruded aluminum housing
- AC Only, Self-Powered or Universal DC
- Pictogram and backplates are mounted into the frame using a pin and channel system
- CSA 22.2 No. 141-15 Performance Certified

## DIMENSIONS

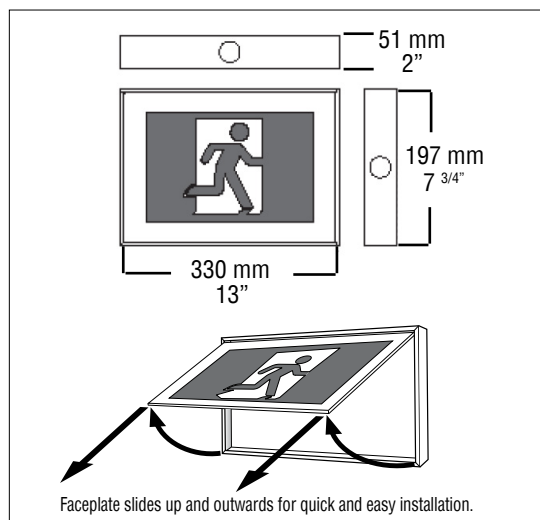

## ELECTRICAL SPECIFICATIONS

If an AC generator is used to back up the signs, a surge suppression device is recommended to protect the entire emergency circuit.

## ORDERING GUIDE

QR-RM -

SERIES	OPERATION	LIGHT SOURCE	FACE#	<sup>3</sup> PICTOGRAM	MOUNTING	OPTIONS
QR-RM	Blank (AC only) SP (Self-powered)	L (LED)	1 (Single) <sup>1</sup> 2 (Double) <sup>2</sup> U (Universal)	OLR (Universal pictograms) 0 (No indicators) L (Left indicator) R (Right indicator) D (Down indicator) U (Up indicator) UR (45° up right) DR (45° down right) UL (45° up left) DL (45° down left)	W (Wall mount no canopy) M (Universal mount wall, ceiling or end)	CC (custom colour - specify) BA (Brushed aluminum finish) WG (Wireguard) PK12 (12" pendant kit) UDC (Universal 6 - 24VDC) 90SP (90 min. emergency) 120SP (120 min. emergency) TP (Tamper proof screws) AT (Auto-test, SP only) SW-OL (RM no indicator, left) <sup>4</sup> 120VDC (Specify 2 or 4 wires) LXN (Lexan shield) SW-OL (RM no indicator, left)

NOTE: <sup>1</sup>Two pictograms or OLR must be ordered - specify; <sup>2</sup>Specify OLR pictogram; <sup>3</sup>For a pictogram and supplementary "EXIT" or "SORTIE" text add "-E" or "-S" after the pictogram nomenclature; <sup>4</sup>With 120VAC only

## EXTERNAL SPECIFICATIONS

The QUADRA is constructed from durable extruded aluminum. The unit comes standard with a white baked powder coat finish. Available in custom poxy-based powder coat finishes (please specify). Single, double or universal face versions must be specified. Universal mounting pattern and key hole slots are stamped into the backplate. The self-powered version comes standard with an external LED status indicator and test switch.

## INTERNAL SPECIFICATIONS

AC ONLY, AC/DC and SELF-POWERED: comes standard configured with high-output LED technology and 120/347VAC input. Nickel-cadmium batteries provide a minimum 30 minutes of emergency duration. Optional 90 or 120 minute duration battery is available. Solid state charger & transfer.

## BATTERY TECHNOLOGY

The QUADRA-SP is designed with a maintenance free, nickel-cadmium battery providing a minimum emergency duration of 30 minutes. An optional 90 or 120 minute nickel-cadmium battery is available. Recharge time of the battery is 24 hours.

## SUPPLEMENTAL TEXT

A running man sign with supplementary "EXIT" or "SORTIE" text is also available in the QUADRA model. To designate "EXIT" add "-E" to the end of the pictogram nomenclature, for "SORTIE" add "-S". For example, a sign with supplementary "EXIT" text and the indicator down to the right would have "DR-E" as it's pictogram nomenclature.

## UNIVERSAL PICTOGRAMS

The OLR (Universal) option includes: a pictogram with no directional indicators, a pictogram with a left facing directional indicator and a pictogram with a right facing directional indicator.

